

ČEPI BLOKA MOTORJA

IME	KODA	D	L	d	l	m	M	jedro
GENERAL MOTORS	07-500	12	40	-	10	3/8 UNC	-	
	07-501	12	40	-	10	3/8 UNC	3/8" NTP	
	07-502	16	54	-	12	7/16 UNC	-	
	07-503	16	54	-	12	7/16 UNC	1/2" NTP	
	07-504	19	54	-	15	5/8 UNC	-	
	07-505	19	54	-	15	5/8 UNC	3/4" NTP	
	07-506	19	85	-	15	5/8 UNC	-	
07-507	19	85	-	15	5/8 UNC	3/4" NTP		
AIFO	07-520	10	18	7	8	-	-	
	07-521	10	18	7	8	-	M12 x 1,5	
	07-522	13	26	10,1	8	-	-	
	07-523	13	26	10,1	8	-	M16 x 1,5	
	07-524	14	26	12	8	-	-	
	07-525	14	26	12	8	-	M18 x 1,5	
	07-526	20	20	14	11	-	-	
07-527	20	20	14	11	-	M28 x 1,5		
CATERPILLAR	07-540	10	38	-	11	1/4 UNC	-	
	07-541	10	38	-	11	1/4 UNC	1/4" G	
	07-542	10	55	-	11	1/4 UNC	-	
	07-543	10	55	-	11	1/4 UNC	1/4" G	
	07-544	12	40	-	10	3/8 UNC	-	
	07-545	12	40	-	10	3/8 UNC	3/8" G	
	07-546	14	33	-	12	5/16 UNC	-	
	07-547	14	26	12	7	-	-	
	07-548	16	41	-	9	7/16 UNF	-	
	07-549	16	41	-	9	7/16 UNF	1/2" G	
	07-550	16	63 (51)	-	13	3/8 UNC	-	
	07-551	16	63	-	13	3/8 UNC	1/2" G	
	07-552	22	20	-	11	5/8 UNF	-	
07-553	22	20	-	11	5/8 UNF	3/4" G		
07-554	28	55	-	20	3/4 UNC	-		
07-555	28	55	-	20	3/4 UNC	1 1/4" G		
CUMMINS	07-560	10	20	-	8	M6	-	
	07-562	16	31	-	13	3/8 UNC	-	
	07-563	16	50	-	10	7/16 16g UNC	-	
	07-564	16	50	-	10	7/16 14g UNC	1/2" G	
	07-565	16	50	-	12	7/16 UNF	-	
	07-566	16	50	-	12	7/16 UNF	1/2" G	
	07-567	18	65	-	15	5/8UNC M16x1,5	-	
RENAULT	07-573	15	22	12	10	-	-	
	07-574	15	22	12	10	-	M18 x 1,5	
VM	07-585	14	20	-	10	M8	-	

Pridržujemo si pravico do sprememb!

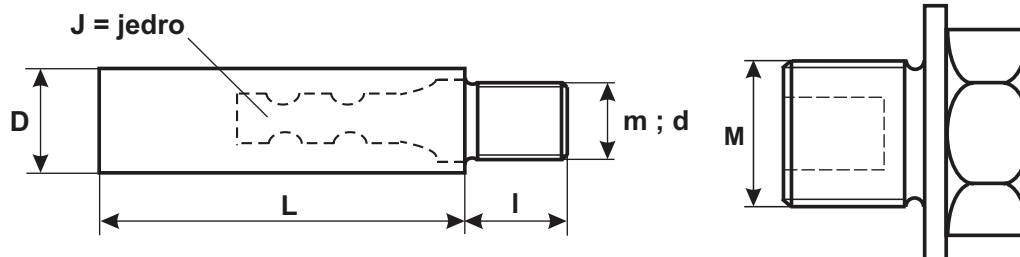
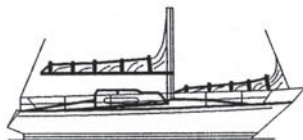

ČEPI BLOKA MOTORJA

IME	KODA	D	L	d	l	m	M	jedro	opomba
LAMBORDINI	07-168	10	18	8	8	-	1/4" NTP		1/4" NTP
	07-602	14	26	12	7	-	1/2" G		
	07-603	14	30	10,1	9	10,1	M18x1,5		0090802840
DMB	07-165	30	16	30,3	6	-	-		
NANNI	07-140	10	18	8	8	-	M16 x 1,5		
DUCATTI	07-150	15	22	-	10	M8	-	J	
BMW	07-110	13	48	-	13	3/8 UNC	-	J	
	07-111	13	48	-	13	3/8 UNC	3/8" TPN	J	
MERCUISER 1,7 TDI	07-230	16	30	13	10	-	1/2" TPN		
	07-231	16	31	13	10	-	-		
RUGGERINI	07-620	20	23	-	-	-	-		
YAMAHA	07-625	20	39	-	11	M8	-		
VOLVO	07-040	16	30	-	10	7/16 UNC	-		
	07-630	16	30	-	10	7/16 UNC	1/2" TPN		
	07-631	16	40	-	10	7/16 UNC 14g	-		
	07-632	16	40	-	10	7/16 UNC 14g	1/2" TPN		
	07-633	16,5	13	-	10	5/16 UNC	-		
	07-634	25	44	-	10	3/8 UNC	-		
07-635	25	44	-	10	3/8 UNC	1" TPN			
YANMAR	07-080	20	20	-	8	M8	-	J	
	07-651	20	37	-	8	M8	-	J	
	07-652	20	55	-	8	M8	-	J	
	07-653	21/30	40	-	15	M8	-	J	
	07-654	23	40	-	8	M8	-	J	
	07-655	30	40	-	8	M8	-	J	
	07-656	40	40	-	15	M10	-	J	
44150	07-657	12	31	-	10	3/8 UNC 16g	-		
18790	07-658	12	31	-	10	3/8 UNC	3/8" NTP		hlad. olja-vode 4 kos/m
	07-659	16	50	-	12	7/16 UNC	-		
	07-660	16	50	-	12	7/16 UNC	1/2" NTP		intercooler 2 kos/motor
KOBOTA	07-668	10	20	8,1	9	-	1/4" NTP		vsi modeli
KHELLER 9kW	07-669	9	43				1/4" NTP		
OSTALI	07-670	10	23	8,1	9	-	1/4" G		
	07-671	16	50	15	12	-	1/2" G		
	07-672	20	80	-	12	M16 x 1,5	3/4" G		
	07-673	16	50	-	12	M16 x 1,5	3/4" G		
	07-680	13	45	-	10	M10	-		
	07-681	13	40	-	9,5	3/8 UNC	-		
	07-682	15	50	-	12	M10	-		
	07-683	9	40	-	10	5/16 UNC	-		
	07-684	9	40	-	10	5/16 UNC	1/4" G		
	07-151	10	50			5/16 18g			

Prilžujemo si pravico do sprememb!